



www.doosan-iv.eu

Doosan Logistics

Warehouse Equipment

Pallet Trucks - Stackers - Order Pickers



Lifting Your Dreams

General Specifications Warehouse Equipment

Contents

Pallet Trucs

LEDH18/20/22/20M/40/50.....	3
LEDH20MP/MPS/MPR.....	4

Stackers

Compact Line: LEDS10C/12.5C/14C/16C.....	5
Heavy Line: LEDS14/16.....	6
Heavy Line: LEDS16IP/20.....	7
Double Stackers: LEDD12.5/18,12.5/20,12.5/20MP.....	8
Double Stackers: LEFD12.5/20.....	9

Order Pickers

LEKF20/LEKH20.....	10
LEKX20.....	11

General Specifications - Pallet Trucks (LEDH18/20/22/20M/40/50)

CHARACTERISTICS										
1	MANUFACTURER				DLE	DLE	DLE	DLE	DLE	DLE
2	MODEL				LEDH18	LEDH20	LEDH22	LEDH20M	LEDH40	LEDH50
3	POWER TYPE				electric	electric	electric	electric	electric	electric
4	CAPACITY	at rated load center		Q kg	1,800	2,000	2,200	2,000	4,000	5,000
5	LOAD CENTER	distance		C mm	600	600	600	600	600	600
6	LOAD DISTANCE			X mm	990	990	990	990	864	864
7	WHEEL BASE			y mm	1337	1337	1337	1350	1446	1446
8	DRIVING MODE				walkie, lateral drive	walkie, lateral drive	walkie, lateral drive	walkie, middle drive	walkie, lateral drive	walkie, lateral drive
WEIGHT										
9	SERVICE WEIGHT	incl. battery		kg	500	520	525	540	861-981	861-981
10	AXLE LOADING	loaded front/rear		kg	915/1385	1013/1507	1095/1630	1028/1512	1149/3509	1331/4327
		unloaded front/rear		kg	410/90	426/94	431/94	441/99	418/240	418/240
TYRES, CHASSIS										
11	TYRES				Vulkollan	Vulkollan	Vulkollan	Vulkollan	Vulkollan	Vulkollan
12	DRIVE WHEEL				mm	Ø230x80	Ø230x80	Ø230x80	Ø254x100	Ø254x100
13	LOAD WHEEL				mm	Ø85/78	Ø85/78	Ø85/78	Ø85/95	Ø85/95
14	SUPPORT WHEEL				mm	Ø125x50	Ø125x50	2x Ø125x50	Ø125x30	Ø125x30
DIMENSIONS										
15	LIFT				h3 mm	120	120	120	120	120
16	HEIGHT	tiller, in drive position		h14 mm	1260	1260	1260	1260	1350	1350
		lowered		h13 mm	85	85	85	85	90	90
17	LENGTH	overall		l1 mm	1683	1683	1683	1699	1644	1644
		to fork faces		l2 mm	490	490	490	503	751	751
18	WIDTH	overall		b1 mm	660	660	660	660	690	690
19	FORKS	dimensions		e/l mm	160/1195	160/1195	160/1195	160/1195	200/1190	200/1190
		distance over forks		b5 mm	520	520	520	520	580/680	580/680
20	GROUND CLEARANCE	centre of wheelbase		m2 mm	35	35	35	35	20	20
21	AISLE WIDTH	for pallets, 800x1200 mm, along		Ast mm	2128	2128	2128	2147	2352	2352
22	TURNING RADIUS			Wa mm	1476	1476	1476	1497	1630	1630
PERFORMANCE										
23	TRAVEL SPEED	loaded/unloaded		km/h	5.66	5.66	5.66	5.66	5.66	5.66
24	GRADEABILITY	loaded/unloaded		%	8/10	8/10	8/10	8/10	8/10	8/10
25	SERVICE BRAKE				regenerative	regenerative	regenerative	regenerative	regenerative	regenerative
MOTOR										
26	AC - DRIVE MOTOR				kW	1.0	1.0	1.0	1.0	2
27	DC - LIFT MOTOR				kW	1.2	1.2	1.2	1.2	2.2
28	BATTERY	acc. to DIN 43535 A/B/C/no			2 EPzS	2 EPzS	2 EPzS	2 EPzS	4 EPzS	4 EPzS
		voltage / nominal capacity		V / Ah	24/230	24/230	24/230	24/230	24/240-360	24/240-360
		weight		kg	210	210	210	210	211-308	211-308
29	IMPULS CONTROL	for drive and lift			AC-impuls	AC-impuls	AC-impuls	AC-impuls	AC-impuls	AC-impuls

Technical specifications are subject to change without notice.

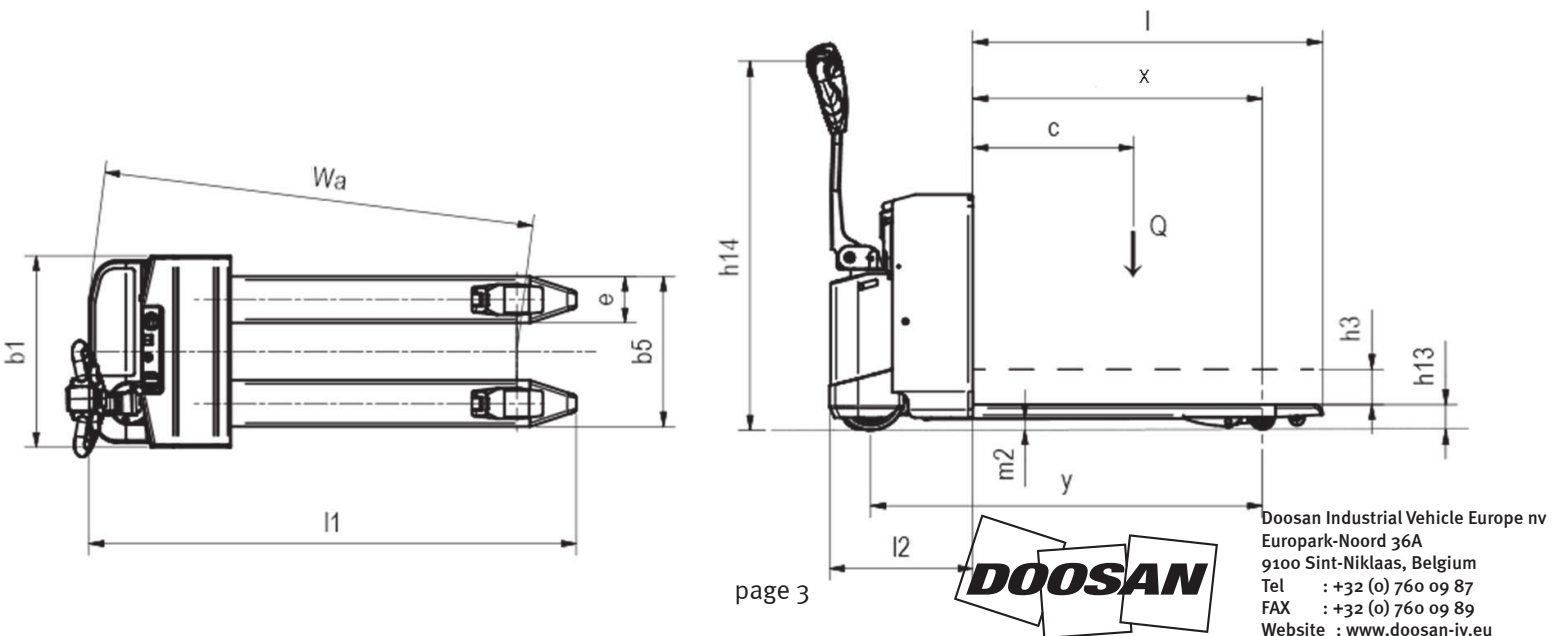

General Specifications - Pallet Trucks (LEDH2oMP/MPS/MPR)

CHARACTERISTICS							
1	MANUFACTURER				DLE	DLE	DLE
2	MODEL				LEDH2oMP	LEDH2oMPS	LEDH2oMPR
3	POWER TYPE				electric	electric	electric
4	CAPACITY	at rated load center	Q	kg	2,000	2,000	2,000
5	LOAD CENTER	distance	C	mm	600	600	600
6	LOAD DISTANCE		X	mm	950	950	950
7	WHEEL BASE		y	mm	1546	1546	1546
8	DRIVING MODE				walkie, middle drive, platform	walkie, middle drive, side protect	walkie, middle drive, rear protect
WEIGHT							
9	SERVICE WEIGHT	incl. battery		kg	830	916	910
10	AXLE LOADING	loaded front/rear		kg	1127/1703	1193/1723	1187/1723
		unloaded front/rear		kg	656/174	722/194	716/194
TYRES, CHASSIS							
11	TYRES				Vulkollan	Vulkollan	Vulkollan
12	DRIVE WHEEL			mm	Ø230x80	Ø230x80	Ø230x80
13	LOAD WHEEL			mm	Ø85/78	Ø85/78	Ø85/78
14	SUPPORT WHEEL			mm	Ø125x50	Ø125x50	Ø125x50
DIMENSIONS							
15	LIFT		h3	mm	120	120	120
16	HEIGHT	tiller, in drive position	h14	mm	1230	1230	1230
		lowered	h13	mm	85	85	85
17	LENGTH	overall	l1	mm	1947	2462	2527
		to fork faces	l2	mm	797	1312	1376
18	WIDTH	overall	b1	mm	700	700	700
19	FORKS	dimensions	e/l	mm	160/1150	160/1150	160/1150
		distance over forks	b5	mm	520/650	520/650	520/650
20	GROUND CLEARANCE	centre of wheelbase	m2	mm	40	40	40
21	AISLE WIDTH	for pallets, 800x1200 mm, along	Ast	mm	2375	2950	2982
22	TURNING RADIUS		Wa	mm	1705	2279	2309
PERFORMANCE							
23	TRAVEL SPEED	loaded/unloaded		km/h	8/9.5	8/9.5	8/9.5
24	GRADEABILITY	loaded/unloaded		%	6/8	6/8	6/8
25	SERVICE BRAKE				regenerative	regenerative	regenerative
MOTOR							
26	AC - DRIVE MOTOR			kW	2.5	2.5	2.5
27	DC - LIFT MOTOR			kW	1	1	1
28	BATTERY	acc. to DIN 43535 A/B/C/no			DIN B	DIN B	DIN B
		voltage / nominal capacity	V / Ah		24/375	24/375	24/375
		weight	kg		300	300	300
29	IMPULS CONTROL	for drive and lift			impuls	impuls	impuls

Technical specifications are subject to change without notice.

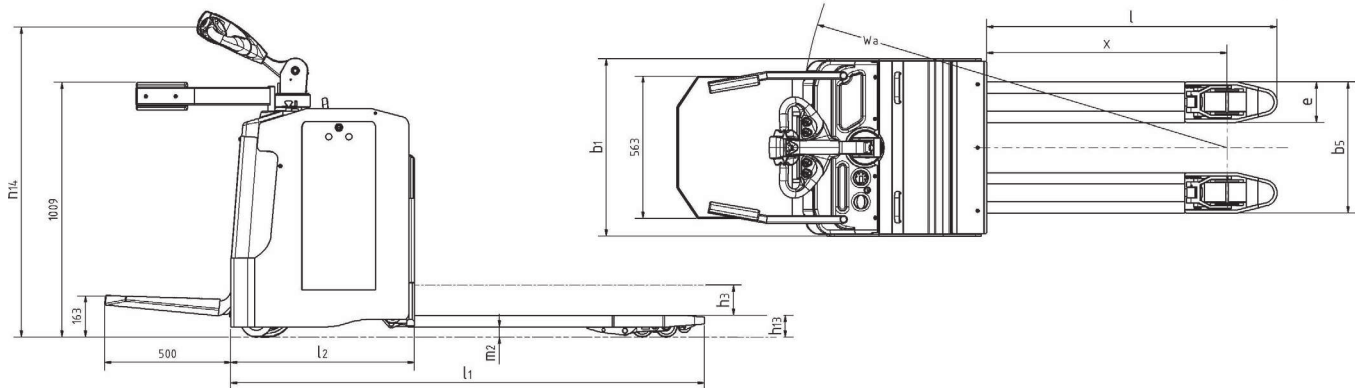

General Specifications - Stackers - compact line (LEDS10C/12.5C/14C/16C)

CHARACTERISTICS										
1	MANUFACTURER				DLE	DLE	DLE	DLE		
2	MODEL				LEDS10C	LEDS12.5C	LEDS14C	LEDS16C		
3	POWER TYPE				electric	electric	electric	electric		
4	CAPACITY	at rated load center		Q	kg	1,000	1,250	1,400	1,600	
5	LOAD CENTER	distance		C	mm	600	600	600	600	
6	LOAD DISTANCE			X	mm	791	791	770	739	
7	WHEEL BASE			y	mm	1329	1329	1337	1337	
8	DRIVING MODE					compact walkie	compact walkie	compact walkie	compact walkie	
WEIGHT										
9	SERVICE WEIGHT	incl. battery			kg	890	890	850	930	
10	AXLE LOADING	loaded front/rear			kg	895/995	954/1139	820/1430	835/1695	
		unloaded front/rear			kg	660/230	660/230	525/325	650/280	
TYRES, CHASSIS										
11	TYRES					Vulkollan	Vulkollan	Vulkollan	Vulkollan	
12	DRIVE WHEEL				mm	Ø230x80	Ø230x80	Ø230x80	Ø230x80	
13	LOAD WHEEL				mm	Ø85/78	Ø85/78	Ø85/78	Ø85/78	
14	SUPPORT WHEEL				mm	Ø125x50	Ø125x50	Ø125x50	Ø125x50	
DIMENSIONS										
15	LIFT				h3	mm	see table			
16	HEIGHT	tiller, in drive position			h14	mm	1250	1250	1260	1260
		lowered			h13	mm	90	90	90	90
17	LENGTH	overall			l1	mm	1875	1875	1900	1928
		to fork faces			l2	mm	680	680	705	737
18	WIDTH	overall			b1	mm	660	660	700	700
19	FORKS	dimensions			e/l	mm	185/1195	185/1195	185/1195/55	185/1190/65
		distance over forks			b5	mm	570	570	570	570
20	GROUND CLEARANCE	centre of wheelbase			m2	mm	32	32	30	20
21	AISLE WIDTH	for pallets, 800x1200 mm, along			Ast	mm	2253	2253	2276	2301
22	TURNING RADIUS				Wa	mm	1481	1481	1490	1490
PERFORMANCE										
23	TRAVEL SPEED	loaded/unloaded			km/h	5.5	5.5	5.5	5.5	
24	LIFT SPEED	loaded/unloaded			m/s	0.15/0.21	0.15/0.21	0.15/0.21	0.15/0.21	
25	LOWERING SPEED	loaded/unloaded			m/s	0.53/0.24	0.53/0.24	0.53/0.24	0.53/0.24	
26	GRADEABILITY	loaded/unloaded			%	7/12	7/12	7/12	7/12	
27	SERVICE BRAKE					regenerative	regenerative	regenerative	regenerative	
MOTOR										
28	AC - DRIVE MOTOR				kW	1	1	1	1	
29	DC - LIFT MOTOR				kW	1.4	1.4	2.2	2.2	
30	BATTERY					special	special	DIN B	DIN B	
		voltage / nominal capacity			V / Ah	24/250	24/250	24/250	24/250	
		weight			kg	250	250	220	220	
31	IMPULS CONTROL	for drive and lift				AC-impuls	AC-impuls	AC-impuls	AC-impuls	

Technical specifications are subject to change without notice.

MAST SPECIFICATIONS								
Lift height mm - h3	LEDS10C		LEDS12.5C		LEDS14C		LEDS16C	
	Closed height mm - h1	Capacity at height kg	Closed height mm - h1	Capacity at height kg	Closed height mm - h1	Capacity at height kg	Closed height mm - h1	Capacity at height kg
1790	1295	1250	1300	1250	1295	1400	1295	1600
2090	1445	1250	1450	1250	1445	1400	1445	1600
2490	1650	1000	1650	1000	1645	1400	1645	1000
2890	1850	800	1850	850	1845	900	n/a	n/a
3290	2050	650	2050	700	2045	750	n/a	n/a
3590	2200	400	2200	500	n/a	n/a	n/a	n/a

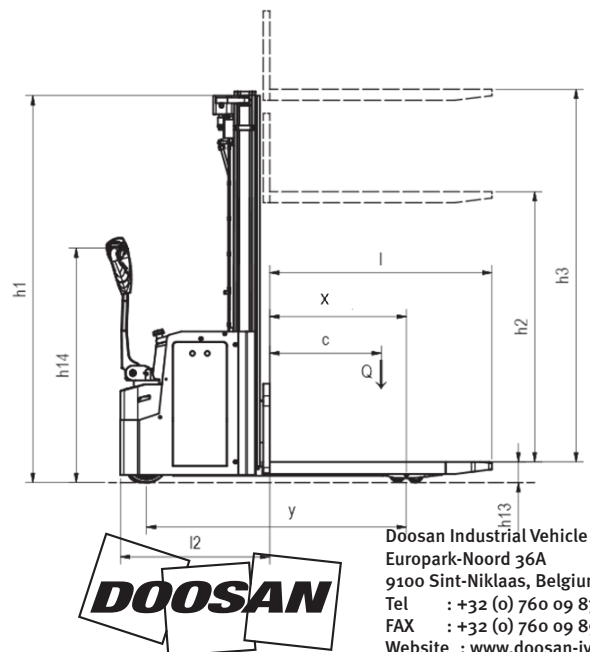
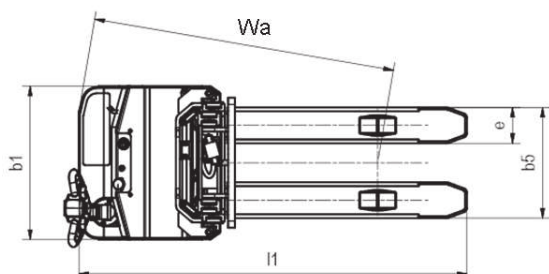

General Specifications - Stackers - heavy line (LEDS14/16)

CHARACTERISTICS											
1	MANUFACTURER				DLE	DLE	DLE	DLE	DLE	DLE	
2	MODEL				LEDS14	LEDS14	LEDS14i	LEDS16	LEDS16	LEDS16i	
3	POWER TYPE				electric	electric	electric	electric	electric	electric	
4	CAPACITY	at rated load center		Q	kg	1,400	1,400	1,400	1,600	1,600	
5	LOAD CENTER	distance		C	mm	600	600	600	600	600	
6	LOAD DISTANCE			X	mm	732	732	837	733	838	
7	WHEEL BASE			y		1325	1398	1614	1326	1397	
8	DRIVING MODE					heavy walkie	heavy walkie	heavy walkie	heavy walkie	heavy walkie	
WEIGHT											
9	SERVICE WEIGHT	incl. battery			kg	950	1260	1460	950	1260	
10	AXLE LOADING	loaded front/rear			kg	910/1440	1000/1660	1170/1690	940/1610	1030/1830	
		unloaded front/rear			kg	700/250	880/380	970/490	700/250	880/380	
TYRES, CHASSIS											
11	TYRES					Vulkollan	Vulkollan	Vulkollan	Vulkollan	Vulkollan	
12	DRIVE WHEEL				mm	ø230x80	ø230x80	ø230x80	ø230x80	ø230x80	
13	LOAD WHEEL				mm	ø85/78	ø85/78	ø85	ø85/78	ø85/78	
14	SUPPORT WHEEL				mm	ø125x50	ø125x50	ø125x50	ø125x50	ø125x50	
DIMENSIONS											
15	LIFT				h3	mm	see table				
		initial lift				mm	-	-	120	-	-
16	HEIGHT	tiller, in drive position			h14	mm	1260	1260	1260	1260	1260
		lowered			h13	mm	90	90	90	90	90
17	LENGTH	overall			l1	mm	1929	2001	2117	1928	2000
		to fork faces			l2	mm	734	806	922	732	804
18	WIDTH	overall			b1	mm	790	790	790	790	
19	FORKS	dimensions			e/l	mm	55/185/1195	55/185/1195	55/185/1195	65/185/1195	65/185/1195
		distance over forks			b5	mm	570	570	570	570	570
20	GROUND CLEARANCE	centre of wheelbase				mm	35	35	25	35	
21	AISLE WIDTH	for pallets, 800x1200 mm, along				mm	2305	2375	2518	2304	
22	TURNING RADIUS				Wa	mm	1490	1560	1778	1490	
PERFORMANCE											
23	TRAVEL SPEED	loaded/unloaded			km/h	5.5	5.5	5.5	5.5	5.5	
24	LIFT SPEED	loaded/unloaded			m/s	0.13/0.20	0.13/0.20	0.13/0.20	0.13/0.20	0.13/0.20	
25	LOWERING SPEED	loaded/unloaded			m/s	0.49/0.23	0.49/0.23	0.49/0.23	0.49/0.23	0.49/0.23	
26	GRADEABILITY	loaded/unloaded			%	7/12	7/12	7/12	7/12	7/12	
27	SERVICE BRAKE					regenerative	regenerative	regenerative	regenerative	regenerative	
MOTOR											
28	AC - DRIVE MOTOR				kW	1	1	1	1	1	
29	DC - LIFT MOTOR				kW	3	3	3	3	3	
30	BATTERY	based on DIN 43535			DIN B	2 EPzS	3EPzS	3EPzS	2EPzS	3EPzS	
		voltage / nominal capacity			V / Ah	24/250	24/375	24/375	24/250	24/375	
		weight			kg	220	300	300	220	300	
31	IMPULS CONTROL	for drive and lift				AC-impuls	AC-impuls	AC-impuls	AC-impuls	AC-impuls	

Technical specifications are subject to change without notice.

MAST SPECIFICATIONS - LEDS 14/16								
				Free Lift (h2)			LEDS14	LEDS16
height of stroke (h13+h3)	overall height (h1) simplex	overall height (h1) duplex	overall height (h1) triplex	simplex SF	duplex DF	triplex TF	rest payload (kg)	rest payload (kg)
2890	1945	1945		0	1400		1400	1600
3590	2295	2295		0	1750		1200	1200
4190			1880				750	800
4390			1950				700	750
4790			2080				600	650

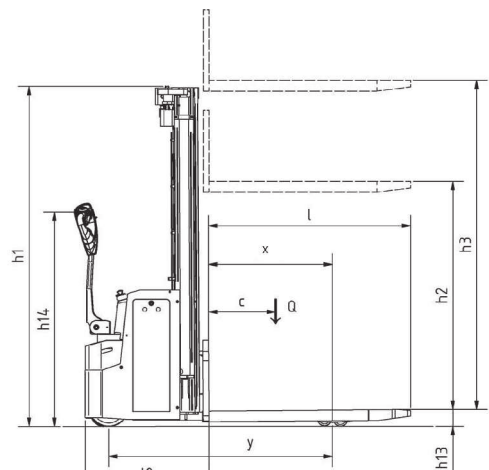
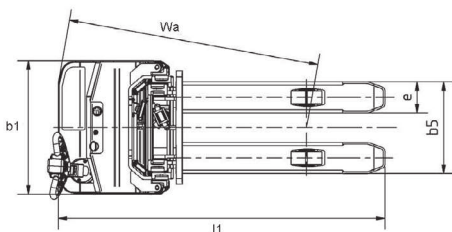

Doosan Industrial Vehicle Europe nv
 Europark-Noord 36A
 9100 Sint-Niklaas, Belgium
 Tel : +32 (0) 760 09 87
 FAX : +32 (0) 760 09 89
 Website : www.doosan-iv.eu

General Specifications - Stackers - heavy line (LEDS16IP & LEDS20)

CHARACTERISTICS						
1	MANUFACTURER				DLE	DLE
2	MODEL				LEDS16IP	LEDS20
3	POWER TYPE				electric	electric
4	CAPACITY	at rated load center	Q	kg	1,600	2,000
5	LOAD CENTER	distance	C	mm	600	600
6	LOAD DISTANCE		X	mm	838	739
7	WHEEL BASE		y	mm	1629	1408
8	DRIVING MODE				platform, initial lift	heavy walkie
WEIGHT						
9	SERVICE WEIGHT	incl. battery		kg	1540	1511
10	AXLE LOADING	loaded front/rear		kg	1480/2060	1232/2279
		unloaded front/rear		kg	640/900	1036/475
TYRES, CHASSIS						
11	TYRES				Vulkollan	Vulkollan
12	DRIVE WHEEL			mm	Ø230x80	Ø230x80
13	LOAD WHEEL			mm	Ø85/75	Ø85/78
14	SUPPORT WHEEL			mm	Ø140x60	Ø140x60
DIMENSIONS						
15	LIFT		h3	mm	see table	
		initial lift	h5	mm	120	n/a
16	HEIGHT	tiller, in drive position	h14	mm	1260	1260
		lowered	h13	mm	90	90
17	LENGTH	overall	l1	mm	2136	2008
		to fork faces	l2	mm	941	812
18	WIDTH	overall	b1	mm	880	880
19	FORKS	dimensions	s/e/l	mm	185/1195	70/185/1195
		distance over forks	b5	mm	570	570
20	GROUND CLEARANCE	centre of wheelbase	m2	mm	25	20
21	AISLE WIDTH	for pallets, 800x1200 mm, along	Ast	mm	2545	2391
22	TURNING RADIUS		Wa	mm	1805	1580
PERFORMANCE						
23	TRAVEL SPEED	loaded/unloaded		km/h	8/9,5	5,5
24	LIFT SPEED	loaded/unloaded		m/s	0.13/.020	0.13/0.20
25	LOWERING SPEED	loaded/unloaded		m/s	0.49/0.23	0.49/0.23
26	GRADEABILITY	loaded/unloaded		%	6/8	6/8
27	SERVICE BRAKE				regenerative	regenerative
MOTOR						
28	AC - DRIVE MOTOR			kW	2,5	1
29	DC - LIFT MOTOR			kW	3	3
30	BATTERY				4 EPzS	4 EPzS
		voltage / nominal capacity		V / Ah	24/500	24/500
31	IMPULS CONTROL				400	400
		weight		kg	400	400
31	IMPULS CONTROL	for drive and lift			AC-impuls	AC-impuls

LEDS16IP

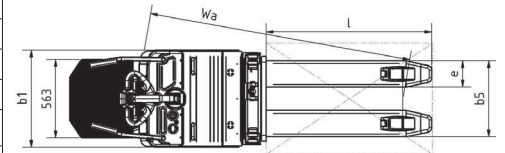
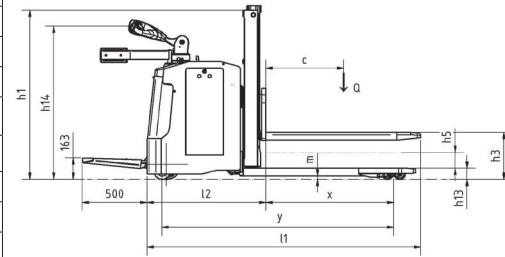

LEDS20

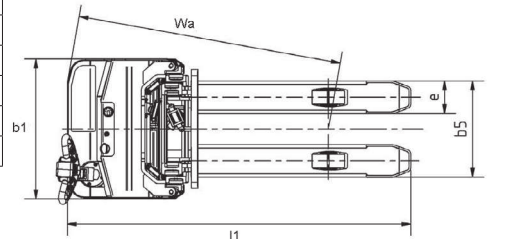
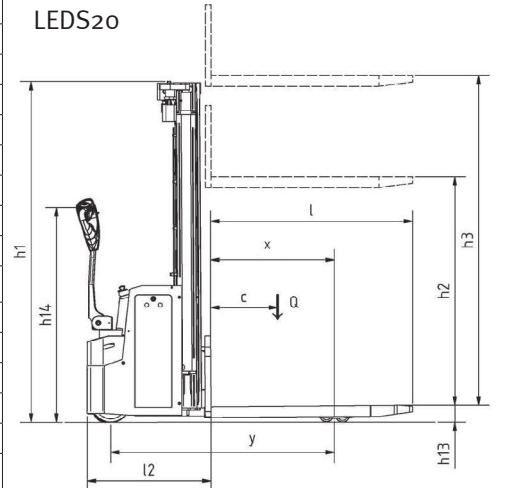

Technical specifications are subject to change without notice.

MAST SPECIFICATIONS - LEDS 16IP							
height of stroke (h13+h3)	overall height (h1) simplex	overall height (h1) duplex	overall height (h1) triplex	Free Lift (h2)			LEDS16IP rest payload (kg)
				simplex SF	duplex DF	triplex TF	
2890	1945	1945		0	1400		1600
3590	2295	2295		0	1750		1200
4190			1880			1370	800
4390			1950			1440	750
4790			2080			1570	650

MAST SPECIFICATIONS - LEDS 20						
height of stroke (h13+h3)	overall height (h1) simplex	overall height (h1) triplex	free lift (h2)		LEDS20 rest payload (kg)	
			simplex SF	triplex TF		
2890	1985		0		2000	
3590	2335		0		1300	
4190		1945		1370	1000	
4390		2080		1440	900	
4790		2210		1570	750	
5390		2370		1770	500	



General Specifications - Double Stackers

(LEDD12.5/18,12.5/20,12.5/20MP)

CHARACTERISTICS						
1	MANUFACTURER			DLE	DLE	DLE
2	MODEL			LEDD12.5/18	LEDD12.5/20	LEDD12.5/20MP
3	POWER TYPE			electric	electric	electric
4	CAPACITY	at rated load center	Q	kg	1,250/1,800	1,250/2,000
5	LOAD CENTER	distance	C	mm	600	600
6	LOAD DISTANCE		X	mm	980	980
7	WHEEL BASE		y	mm	1512	1512
8	DRIVING MODE				walkie	walkie
WEIGHT						
9	SERVICE WEIGHT	incl. battery		kg	830	830
10	AXLE LOADING	loaded front/rear		kg	1015/1615	1070/1760
		unloaded front/rear		kg	615/215	615/215
TYRES, CHASSIS						
11	TYRES				Vulkollan	Vulkollan
12	DRIVE WHEEL			mm	Ø230x80	Ø230x80
13	LOAD WHEEL			mm	Ø85/78	Ø85/78
14	SUPPORT WHEEL			mm	Ø125x50	Ø125x50
DIMENSIONS						
15	LIFT		h3	mm	see table	
		initial lift	h5	mm	120	120
16	HEIGHT	tiller, in drive position	h14	mm	1260	1260
		lowered	h13	mm	90	90
17	LENGTH	overall	l1	mm	1860	2185
		to fork faces	l2	mm	660	990
18	WIDTH	overall	b1	mm	660	700
19	FORKS	dimensions	s/e/l	mm	55/185/1195	55/185/1195
		distance over forks	b5	mm	570	570
20	GROUND CLEARANCE	centre of wheelbase	m2	mm	35	25
21	AISLE WIDTH	for pallets, 800x1200 mm, along	Ast	mm	2325	2573
22	TURNING RADIUS		Wa	mm	1670	1920
PERFORMANCE						
23	TRAVEL SPEED	loaded/unloaded		km/h	5.6	8/9.5
24	LIFT SPEED	loaded/unloaded		m/s	0.15/0.23	0.15/0.23
25	LOWERING SPEED	loaded/unloaded		m/s	0.5/0.26	0.5/0.26
26	GRADEABILITY	loaded/unloaded		%	8/10	6/8
27	SERVICE BRAKE				regenerative	regenerative
MOTOR						
28	AC - DRIVE MOTOR			kW	1	2.5
29	DC - LIFT MOTOR			kW	1.4	1.4
					2 EP2S	2 EP2S
30	BATTERY	voltage / nominal capacity		V / Ah	24/230	24/375
		weight		kg	250	300
31	IMPULS CONTROL	for drive and lift			AC-impuls	impuls

MAST SPECIFICATIONS		
	LEDD12.5/18, LED12.5/20	
Lift height mm - h3	Closed height mm - h1	Capacity at height kg
1790	1295	1250
2090	1445	1000
2490	1645	700

LEDD12.5/20MP		
	Closed height mm - h1	Capacity at height kg
Lift height mm - h3	1300	1250
2090	1450	1250

Technical specifications are subject to change without notice.

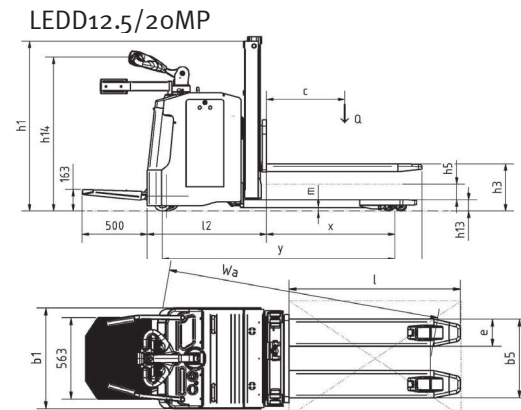
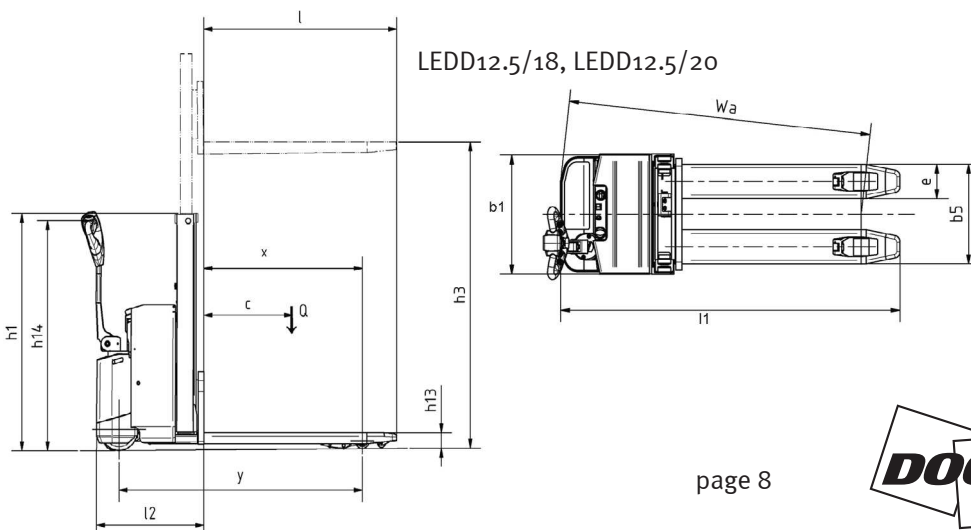

General Specifications - Double Stackers (LEFD12.5/20)

CHARACTERISTICS					
1	MANUFACTURER				DLE
2	MODEL				LEFD12.5/20
3	POWER TYPE				electric
4	CAPACITY	at rated load center	Q	kg	1,250/2,000
5	LOAD CENTER	distance	C	mm	600
6	LOAD DISTANCE		X	mm	985
7	WHEEL BASE		y	mm	1712
8	DRIVING MODE				rider
WEIGHT					
9	SERVICE WEIGHT	incl. battery		kg	1385
10	AXLE LOADING	loaded front/rear		kg	1483/1902
		unloaded front/rear		kg	1033/352
TYRES, CHASSIS					
11	TYRES				Vulkollan
12	DRIVE WHEEL			mm	Ø254x100
13	LOAD WHEEL			mm	Ø85/78
14	SUPPORT WHEEL			mm	Ø125x50
DIMENSIONS					
15	LIFT		h ₃	mm	see table
		initial lift	h ₅	mm	100
16	HEIGHT	lowered	h ₁₃	mm	90
		overall	l ₁	mm	2096
17	LENGTH	to fork faces	l ₂	mm	901
		overall	b ₁	mm	800
18	WIDTH	overall	b ₁	mm	800
		dimensions	s/e/l	mm	55/185/1195
19	FORKS	distance over forks	b ₅	mm	570
		centre of wheelbase	m ₂	mm	25
20	GROUND CLEARANCE	centre of wheelbase	m ₂	mm	25
21	aisle width	for pallets, 800x1200 mm, along	Ast	mm	2553
22	TURNING RADIUS		Wa	mm	1899
PERFORMANCE					
23	TRAVEL SPEED	loaded/unloaded		km/h	9.5/11
24	LIFT SPEED	loaded/unloaded		m/s	0.15/0.23
25	LOWERING SPEED	loaded/unloaded		m/s	0.5/0.26
26	GRADEABILITY	loaded/unloaded		%	6/12
27	SERVICE BRAKE				regenerative
MOTOR					
28	AC - DRIVE MOTOR			kW	2.5
29	DC - LIFT MOTOR			kW	1.4
30	BATTERY				4 EPzS
		voltage / nominal capacity		V / Ah	620
		weight		kg	550
31	IMPULS CONTROL	for drive and lift			AC-impuls

Technical specifications are subject to change without notice.

MAST SPECIFICATIONS		
Lift height mm - h ₃	Closed height mm - h ₁	Capacity at height kg
1790	1300	1250

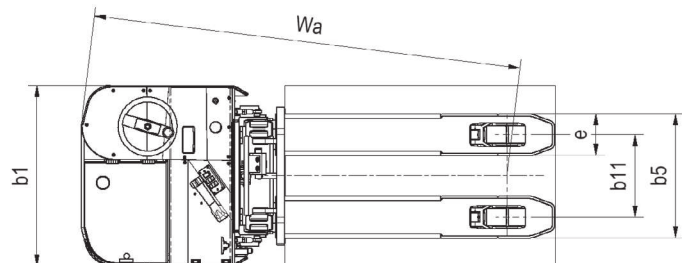
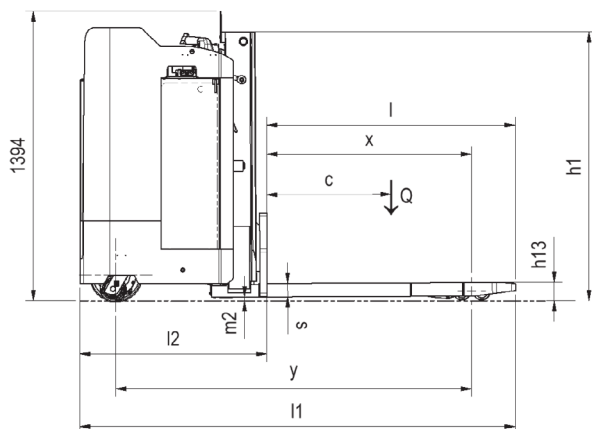

General Specifications - Order Pickers (LEKF20/LEKH20)

CHARACTERISTICS							
1	MANUFACTURER				DLE	DLE	DLE
2	MODEL				LEKF20	LEKF20	LEKH20
3	POWER TYPE				electric	electric	electric
4	CAPACITY	at rated load center	Q	kg	2,000	2,000	2,000
5	LOAD CENTER	distance	C	mm	1200	600	1,200
6	LOAD DISTANCE		X	mm	1835	952	1585
7	WHEEL BASE		y	mm	3013	2130	2160
8	DRIVING MODE				rider	rider	rider
WEIGHT							
9	SERVICE WEIGHT	(e) = excl. battery, (i) = incl. battery		kg	1158 (i)	1001 (i)	750 (e)
10	AXLE LOADING	loaded front/rear		kg	1248/1910	1030/1971	1248/1910
		unloaded front/rear		kg	826/332	700/301	826/332
TYRES, CHASSIS							
11	TYRES				Vulkollan	Vulkollan	Vulkollan
12	DRIVE WHEEL			mm	Ø230x80	Ø230x80	Ø230x80
13	LOAD WHEEL			mm	Ø85/78	Ø85/78	Ø85/78
14	SUPPORT WHEEL			mm	Ø140x60	Ø140x60	Ø140x60
DIMENSIONS							
15	LIFT		h3	mm	120	120	90
16	HEIGHT	lowered	h13	mm	85	85	90
17	LENGTH	overall	l1	mm	3725	2486	3610
		to fork faces	l2	mm	1337	1337	1255
18	WIDTH	overall	b1	mm	700	700	700
		forks	e/l	mm	180/2390	160/1150	180/2390
19	FORKS	dimensions	e/l	mm	180/2390	160/1150	180/2390
		distance over forks	b5	mm	540	520	540
20	GROUND CLEARANCE	centre of wheelbase	m2	mm	30	30	30
21	AISLE WIDTH	for pallets, 800x1200 mm, along	Ast	mm	4074	3072	4060
22	TURNING RADIUS		Wa	mm	3181	2302	2845
PERFORMANCE							
23	TRAVEL SPEED	loaded/unloaded		km/h	8/9.5	8/9.5	8/9.5
24	GRADEABILITY	loaded/unloaded		%	6/8	6/8	6/8
25	SERVICE BRAKE				regenerative	regenerative	regenerative
MOTOR							
26	AC - DRIVE MOTOR			kW	2.5	2.5	2.6
27	DC - LIFT MOTOR			kW	1.2	1.2	2.2
28	BATTERY	acc. to DIN 43535 A/B/C/nl		3 EPzS	DIN B	DIN B	DIN B
		voltage / nominal capacity		V / Ah	24/375	24/375	24/375
		weight		kg	300	300	300
29	IMPULS CONTROL	for drive and lift			AC-impuls	AC-impuls	AC-impuls

Technical specifications are subject to change without notice.

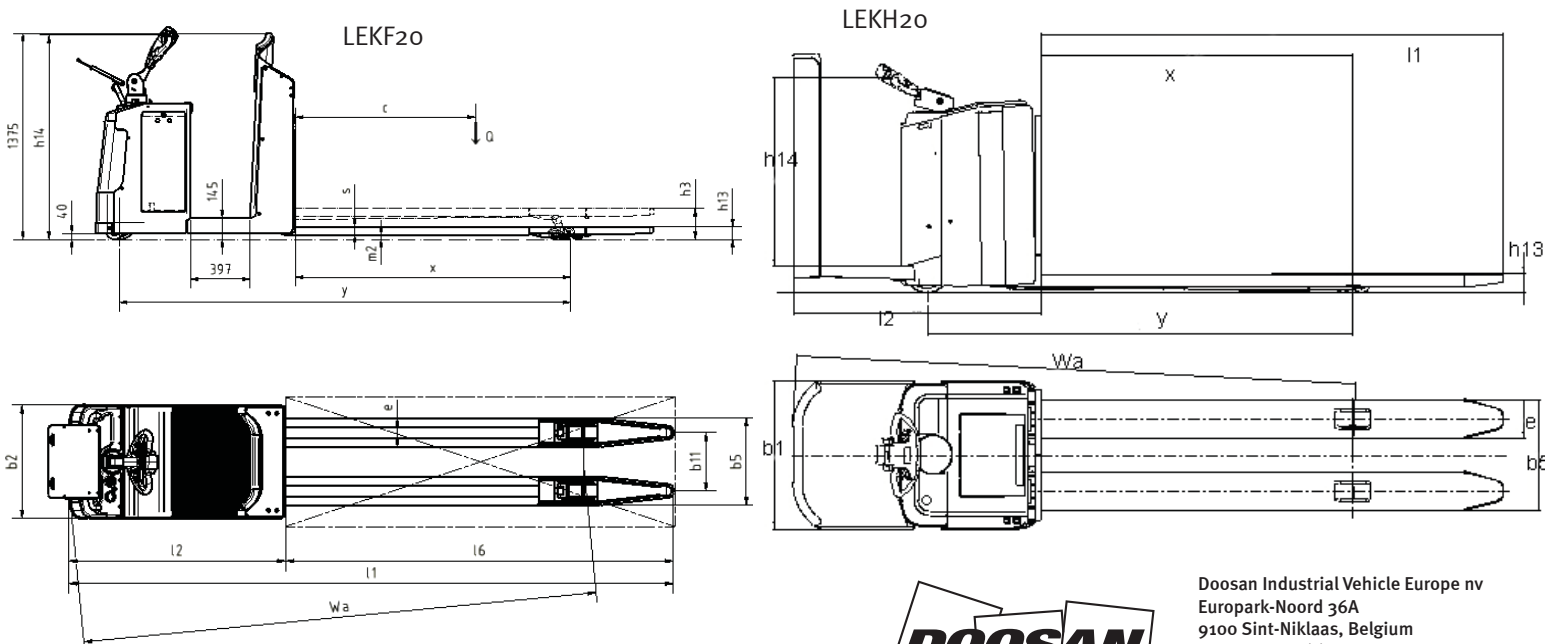

General Specifications - Order Pickers (LEKX20)

CHARACTERISTICS					
1	MANUFACTURER				DLE
2	MODEL				LEKX20
3	POWER TYPE				electric
4	CAPACITY	at rated load center	Q	kg	2,000
5	LOAD CENTER	distance	C	mm	1,200
6	LOAD DISTANCE		X	mm	1585
7	WHEEL BASE		y	mm	2160
8	DRIVING MODE				rider
WEIGHT					
9	SERVICE WEIGHT	(e) = excl. battery, (i) = incl. battery		kg	900 (e)
10	AXLE LOADING	loaded front/rear		kg	1248/1910
		unloaded front/rear		kg	826/332
TYRES, CHASSIS					
11	TYRES				Vulkollan
12	DRIVE WHEEL			mm	Ø230x80
13	LOAD WHEEL			mm	Ø85/78
14	SUPPORT WHEEL			mm	Ø140x60
DIMENSIONS					
15	LIFT		h3	mm	90
16	HEIGHT	lowered	h13	mm	700
17	LENGTH	overall	l1	mm	3670
		to fork faces	l2	mm	1220
18	WIDTH	overall	b1	mm	765
19	FORKS	dimensions	e/l	mm	200/2350
		distance over forks	b5	mm	570
20	GROUNDCLEARANCE	centre of wheelbase	m2	mm	22
21	AISLE WIDTH	for pallets, 800x1200 mm, along	Ast	mm	4120
22	TURNING RADIUS		Wa	mm	2850
PERFORMANCE					
23	TRAVEL SPEED	loaded/unloaded		km/h	8/9.5
24	LIFT SPEED	loaded/unloaded		m/s	0.13/0.09
25	LOWERING SPEED	loaded/unloaded		m/s	0.30/0.10
26	GRADEABILITY	loaded/unloaded		%	6/8
27	SERVICE BRAKE				regenerative
MOTOR					
28	AC - DRIVE MOTOR			kW	2.6
29	DC - LIFT MOTOR			kW	2.2
30	BATTERY	acc. to DIN 43535 A/B/C/nl		3 EPzS	DIN B
		voltage / nominal capacity		V / Ah	24/375
		weight		kg	300
31	IMPULS CONTROL	for drive and lift			AC-impuls

Technical specifications are subject to change without notice.

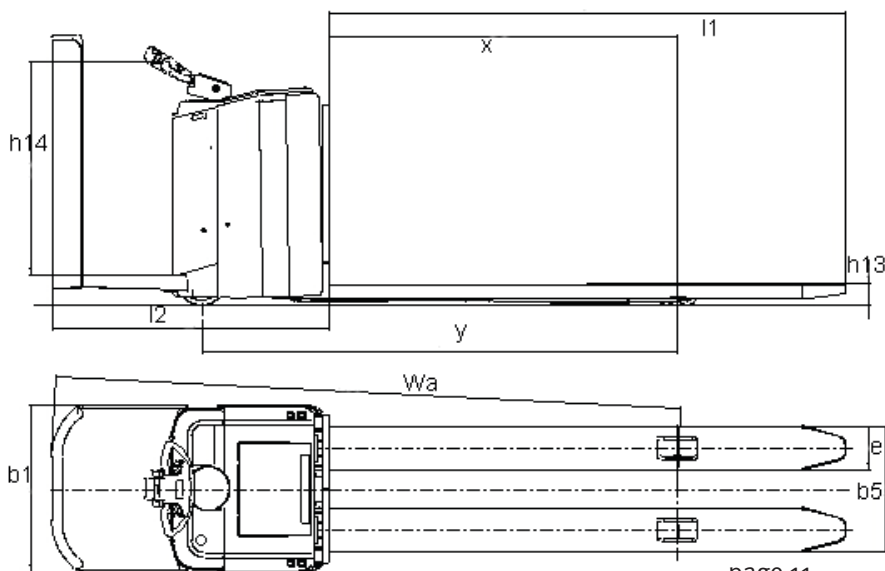



Meet the rest of the Doosan Family



I.C. Truck

Diesel 1.5t-16.0t
LPG 1.5t-7.0t
Cushion 1.5t-5.5t



Electric Counterbalanced Truck

3 Wheel 1.3t-2.0t
4 wheel 1.5t-5.0t
Cushion 1.5-3.2t

Doosan Industrial Vehicle Europe

HQ Europe

Europark-Noord 36A
9100 Sint-Niklaas
(Belgium)

French Branch

ZAC de la Clef St. Pierre Buroplus 2
1a avenue Jean d'Alembert
78990 Elancourt

German Branch

Rolandstraße 5
45128 Essen

Italian Branch

Via Dante Alighieri 43
20851 Lissone (MB)

DEALER STAMP